

RDS 100

Technical data

FEATURES

- ▶ Easy mounting concept without expensive kits
- ▶ Adjustable detection angle
- ▶ Wide detection area
- ▶ Very compact sensor



MICROWAVE / RADAR

Technology	Microwave Doppler radar
Transmitter frequency	24.150 GHz
Transmitter radiated power	< 20 dBm EIRP
Transmitter power density	< 5 mW/cm ²
Min. detection speed	5 cm/s
Detection area	4 m × 2 m at 2.2 m

MECHANICAL

Mounting height	From 1.8 m up to 4 m
Dimensions (w × h × l)	76 × 48 × 116 mm
Housing material	ABS, PC
Enclosure rating	IP54
Temperature range	-20°C ... +55°C
Operating humidity level	< 95% RH
Tilt angles	0° to 90° vertical -30° to +30° lateral

ELECTRICAL

Supply voltage U _{sp}	10 ... 30 VDC / 12 ... 24 VAC	
Typ. current consumption at 24 VDC	< 30 mA	
Output	Solid-state relay	
Max. switching voltage	50 V	
Max. switching current	250 mA	
Max. release time	1.5 s	
Indication LED (red):	LED on	Object detected
	LED off	No object detected

CONNECTION CABLE

Length	2.2 m
Diameter	Ø 4 mm
Material	PVC, gray
Wires	AWG26
• red	+U _{SP} / V _{CC}
• black	GND (0 V) / V _{CC}
• blue	Output COM
• green	Output NO

GENERAL

EMC emission	EN 61000-6-3:2007, EN 12015:2014
EMC immunity	EN 61000-6-2:2005, EN 12016:2013
Vibration	IEC 60068-2-6:2007
Shock	IEC 60068-2-27:2008
RoHS	2011/65/EU
Certificate	CE



CEDES AG is certified according to ISO 9001: 2015.

Dimensions

All dimensions in mm
 Proportions not to scale

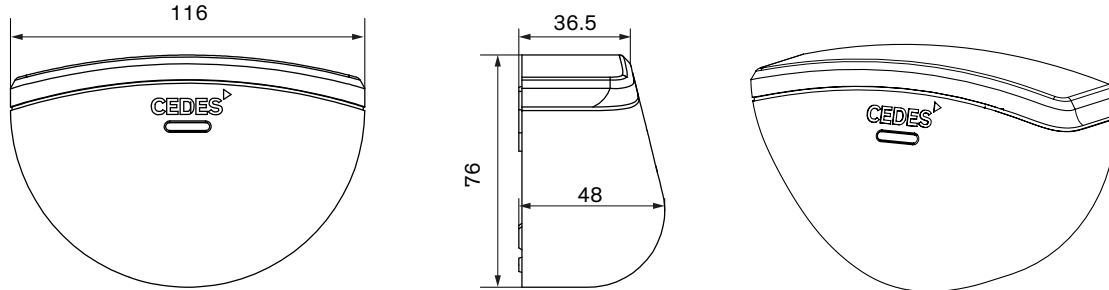

Output logic

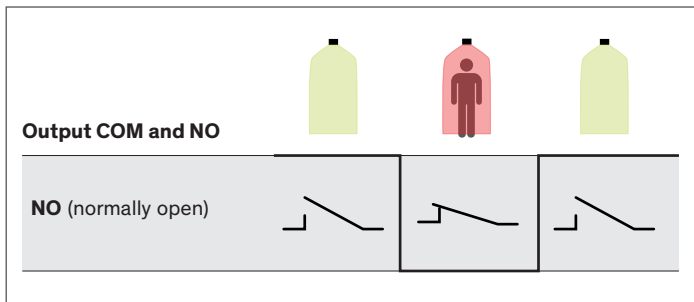

Electrical connection

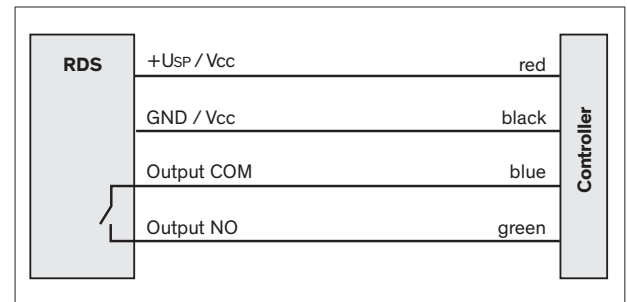

Applications

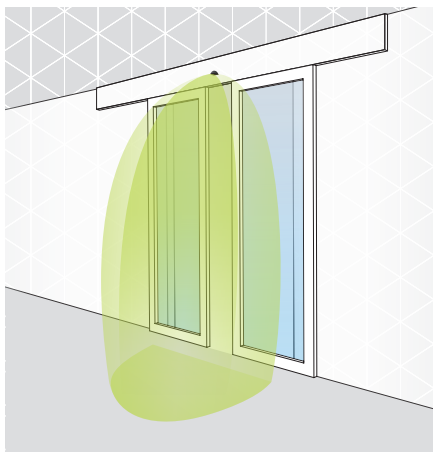

Door activation for sliding doors

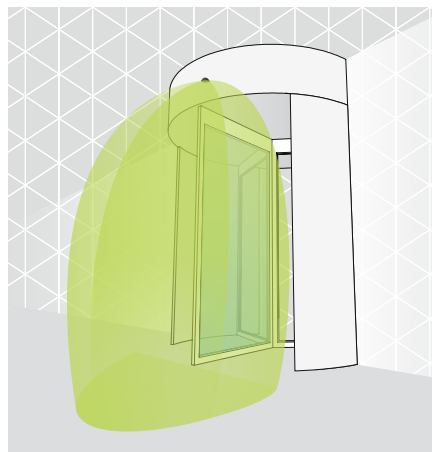

Door activation for revolving doors

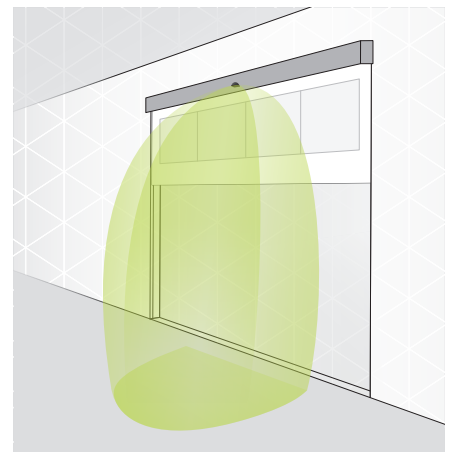

Door activation for industrial doors